

## BLOC B

TYPE : F3 B2	SURFACE (m <sup>2</sup> )
Salon	20.33
Cuisine	10.40
Chambre 01	18.25
Chambre 02	10.68
Hall	8.00
SDB	3.43
WC	1.65
Balcon	/
Sechoir	8.85
Surface Totale	83.60

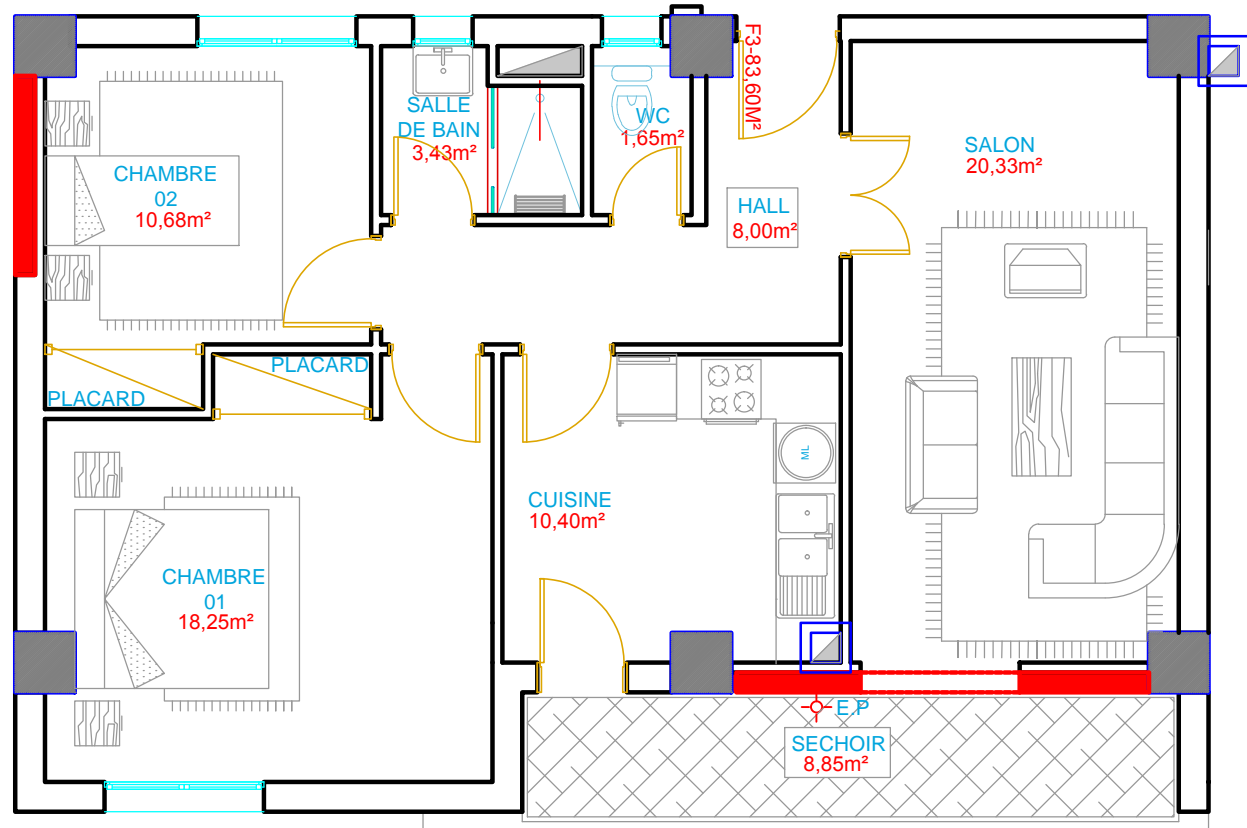

**BLOC B F3 B2 (83.60m<sup>2</sup>)**

**DU 1ER AU 10EME  
ETAGE**